

Suite 1600

Riverpark II
300 park ave

19,664 SF

AVAILABLE 11/1/2026

Includes Server Rooms with Dedicated HVAC - 10 tons

- 3 Conference Rooms
- 5 Huddle Rooms
- 1 Recording Room
- 2 Restrooms
- 3 Storage Rooms
- 1 Lab
- 1 Electrical
- 1 Mechanical
- 1 Break Room
- 1 Board Room

Erik Hallgrimson, CCIM

408 888 8210

erik.hallgrimson@cushwake.com

CA License #01274540

Brandon Bain

408 242 3176

brandon.bain@cushwake.com

CA License #01308375

Kate Myers

408 502 0196

kate.myers@cushwake.com

CA License 02253804

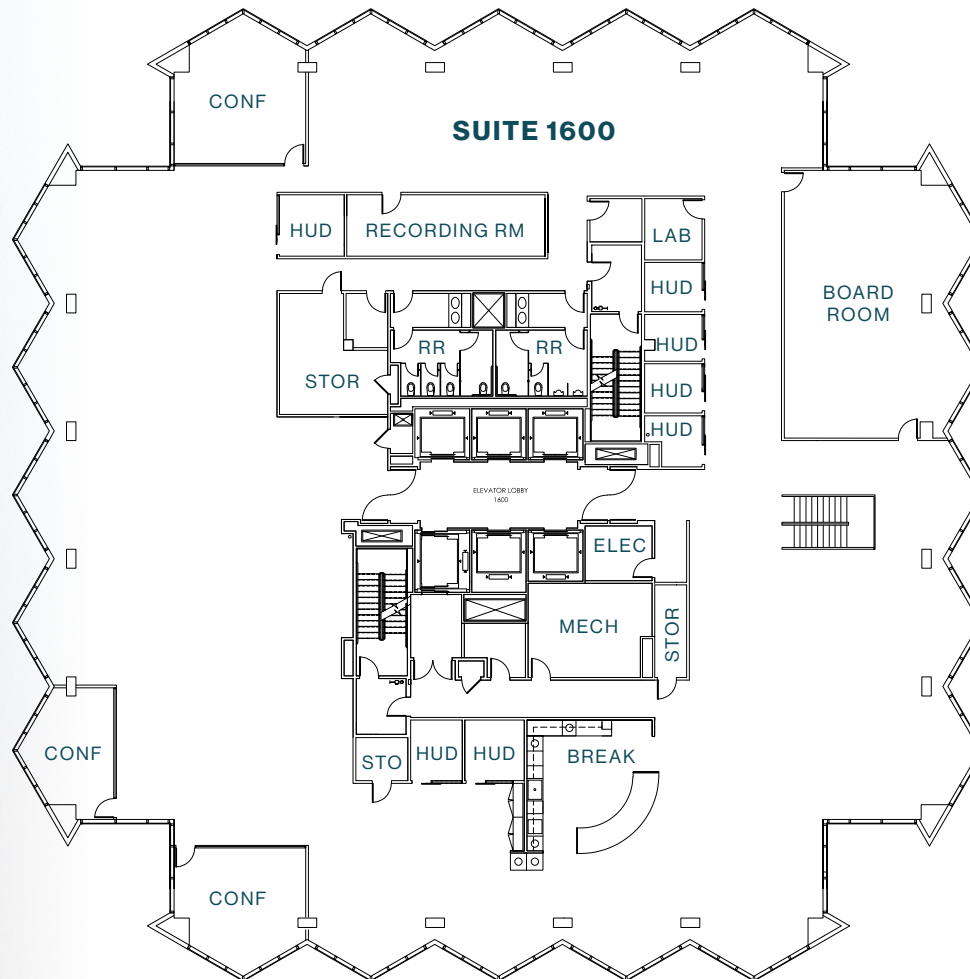

©2026 Cushman & Wakefield. All rights reserved. The information contained in this communication is strictly confidential. This information has been obtained from sources believed to be reliable but has not been verified. NO WARRANTY OR REPRESENTATION, EXPRESS OR IMPLIED, IS MADE AS TO THE CONDITION OF THE PROPERTY (OR PROPERTIES) REFERENCED HEREIN OR AS TO THE ACCURACY OR COMPLETENESS OF THE INFORMATION CONTAINED HEREIN, AND SAME IS SUBMITTED SUBJECT TO ERRORS, OMISSIONS, CHANGE OF PRICE, RENTAL OR OTHER CONDITIONS, WITHDRAWAL WITHOUT NOTICE, AND TO ANY SPECIAL LISTING CONDITIONS IMPOSED BY THE PROPERTY OWNER(S). ANY PROJECTIONS, OPINIONS OR ESTIMATES ARE SUBJECT TO UNCERTAINTY AND DO NOT SIGNIFY CURRENT OR FUTURE PROPERTY PERFORMANCE. COE-PM-West-05.22.2026